

Installing Read&Write for Windows

1. Click below to view the preferred system requirements:
<https://support.texthelp.com/help/system-requirements>
2. Click the link below to access the Read&Write installation file:
<http://fastdownloads2.texthelp.com/readwrite12/installers/au/read&write.exe>
3. Click Save, and the file read&write.exe should automatically begin downloading into your default Downloads folder.

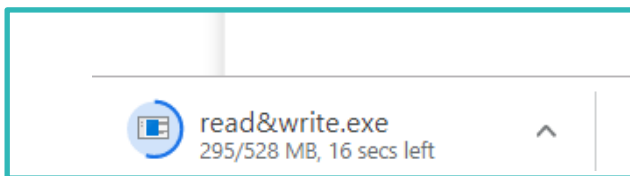

4. Locate the read&write.exe file you just downloaded, then double click the file to run the Read&Write installer.
5. Once you get the screen below, click the Accept and Install button

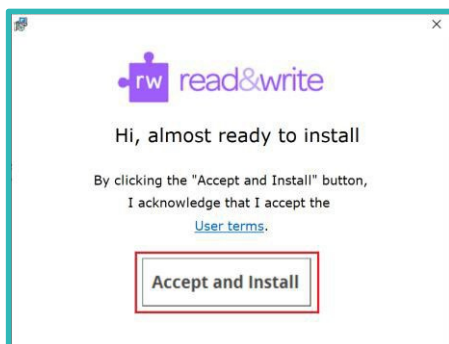

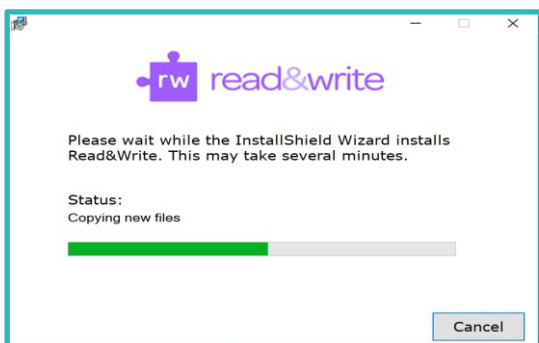

Installation Process

1. The screen below will appear once the installation process begins

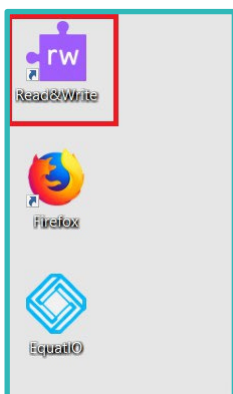

2. Once the installer completes the installation, it will create a Read&Write icon on your desktop screen.
3. Simply double click the Read&Write icon to open the app



You can also find the file by clicking on the Windows icon  then scroll down until you locate the Texthelp folder. Click on the dropdown to show more options and you will find the Read&Write program icon.

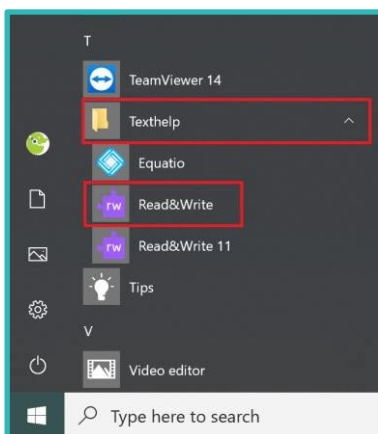

Signing in

When running Read&Write for the first time, you will be required to sign in to access Premium features. To sign in to Read&Write:-

1. Click the icon on the top of your Read&Write toolbar

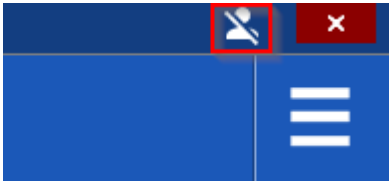

2. Select the sign in with Microsoft option

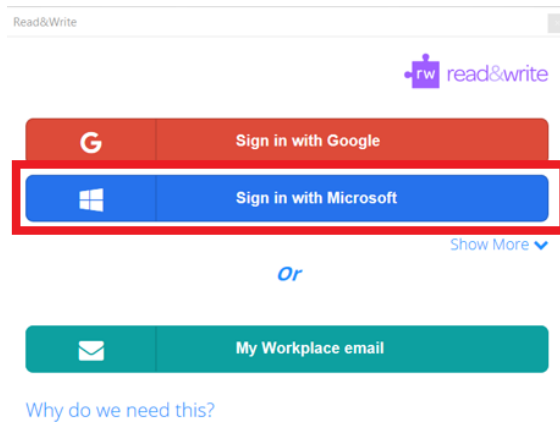

3. Sign in with your TAFESA email account.

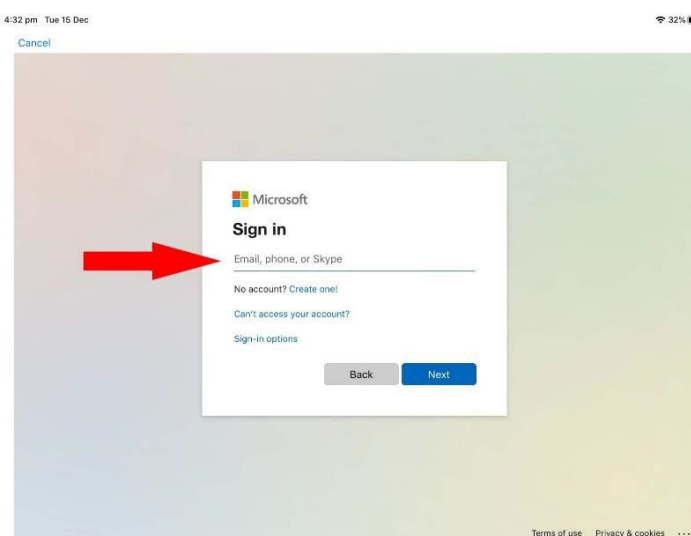

TAFE SA Read&Write software installation guide-Android August 2024 V1

For further installation support, please visit: <https://support.texthelp.com/help> or contact TextHelp support@texthelp.com.